

# SmartK-03

(Instruction manual for semi-automatic box opening machine)

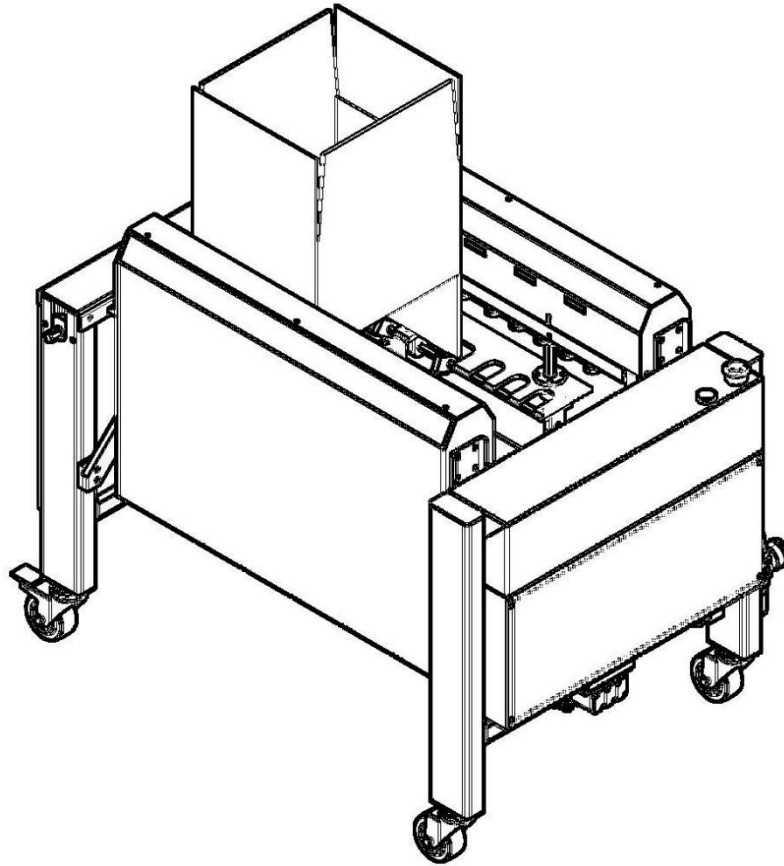

Shanghai Bashe Intelligent Equipment Co., Ltd.

# Preface

Thank you for choosing the SmartK-03 semi-automatic box opening machine developed and manufactured by our company. SmartK-03 The semi-automatic box opening machine condenses our company's technical achievements for many years, with more complete functions and better operation. A series of advantages such as convenience, more stable and reliable performance, etc., are carefully developed to adapt to the modern development trend New products.

This product is easy to adjust and reasonable in structure design, which effectively improves the performance and work efficiency of the machine.rate. Please read this manual carefully before installation and use, it will help you understand the basics of the machine The performance, structure, operation and maintenance methods are convenient for you to use the machine correctly and make it play the best Yes, reduce failures and extend service life .

## **Special statement:**

1. The company reserves the right to interpret all the parameters and contents described in the manual;
2. The company reserves the right to make technical changes to the product without prior notice.

# Table of Contents

1. Uses and features .....	1
2. Main technical parameters .....	2
3. Panel function description .....	3
4. the appearance and structure of the machine and the names of its components .....	3
5. Instructions for use.....	4
6. circuit diagram.....	11
7. gas circuit diagram .....	12
8. Common troubleshooting .....	13
9. maintenance and maintenance .....	13
Maintenance records and feedback forms.....	14

## 1. Uses and features

### Use:

Semi-automatic box opening machine equipment, the user only needs to simply put the box blanks into the box opening station, and the Now the bottom front and rear covers and side covers are automatically folded, and the current state can be maintained for workers to carry out Boxing. Widely used in logistics e-commerce, home appliances, textiles, food, cosmetics, daily necessities, medical Pharmaceutical, chemical and other manufacturing industries.

### Features:

- ◆ This machine is easy to adjust, only need to adjust two positions, and the switch specification can be completed within 30 seconds.
- ◆ It occupies a small area and is widely used in e-commerce warehousing and other places.
- ◆ This machine is equipped with a carton sealing machine in the back of the machine to solve the problem that customers have many types of products and need frequent switching.
- ◆ The specifications cover the postal standard box 1-12# box.
- ◆ The fastest working speed can reach 10 cases/min.
- ◆ This machine can be used as a stand-alone machine, or it can be used in conjunction with a production line.

## 2.Main technical parameters

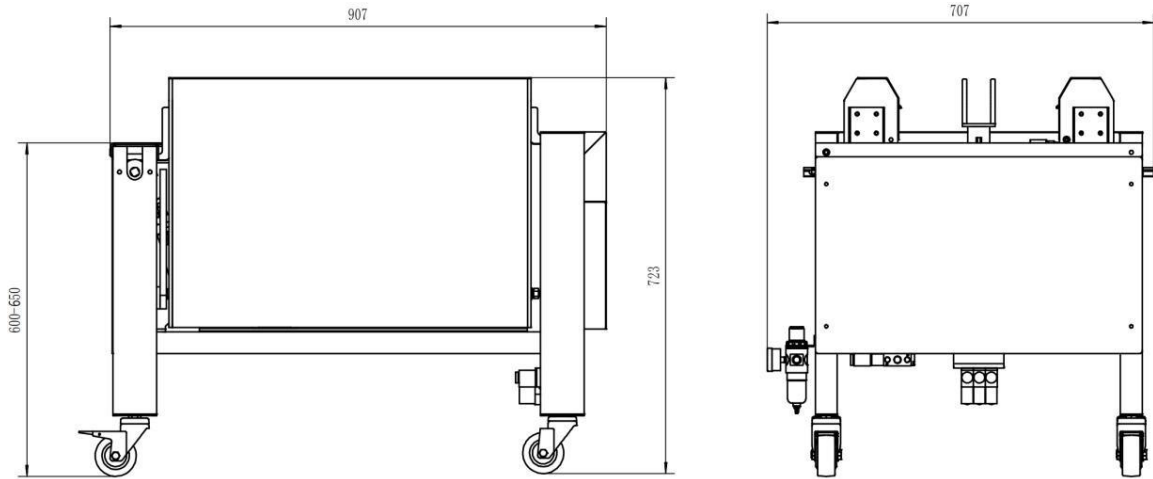

model	SmartK-03
voltage	AC110V/60Hz
power	50W
speed	10 boxes/minute
Height of working table	23.63-25.60in
Drive method	Cylinder drive
Maximum carton size (length×width)	20.87×11.42 in
Minimum carton size (length×width)	5.12×3.15 in
Dimensions (length×width×height)	35.71×27.83×28.46 in
Machine weight	176.37 lb

### 3. Panel function description

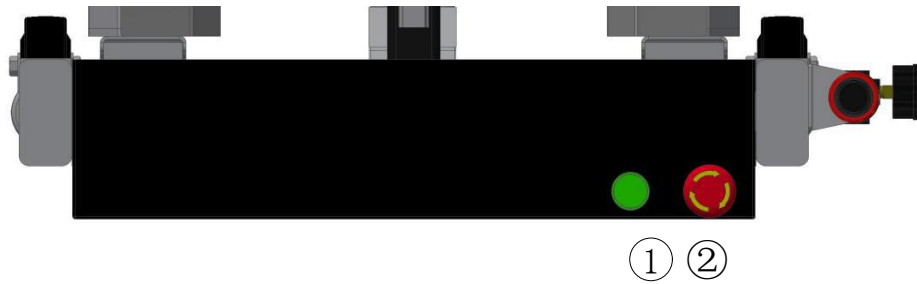

- ①. Power switch: start the device after pressing it (provided that the emergency stop button has been unscrewed).
- ②. Emergency stop button: press to cut off the power and gas, it can be used in emergency, stop, and switch specifications

### 4.The machine appearance structure and component names

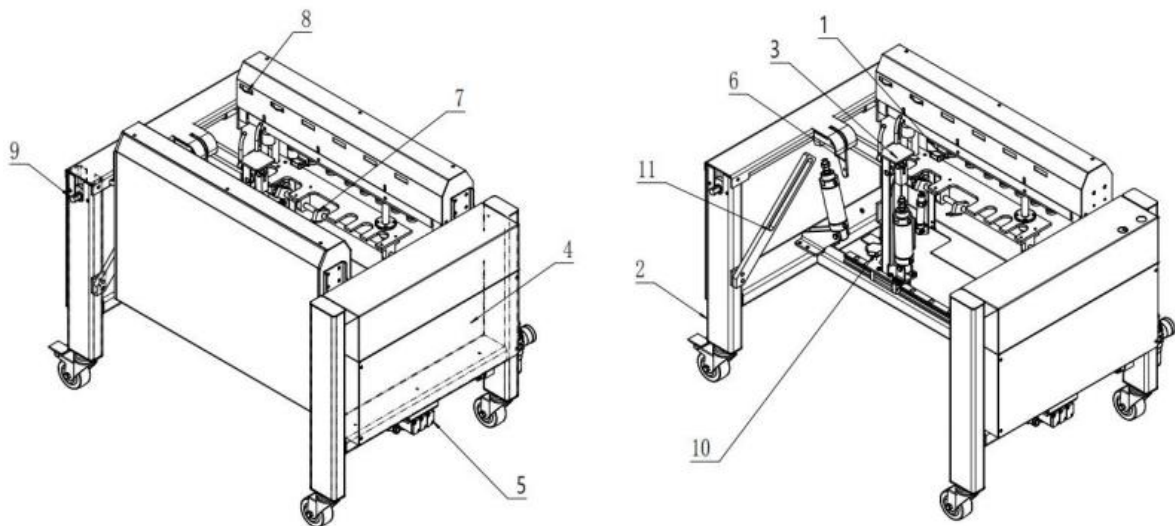

- 1、 Folding side wing parts      2、 Rack components      3、 Folded rear wing parts
- 4、 Electrical box      5、 Pneumatic components      6、 Folding Thousand Wing Parts
- 7、 Hitting parts      8、 Carton clamping mechanism      9、 Adjust the screw left and right
- 10、 Front and rear adjustment handle      11、 Follow-up tracking mechanism

## 5. Instructions for use

5.1 Open the outer packing box, place the machine on a flat ground, and check the moving parts of the machine Whether it is flexible, whether there is jamming, whether there are signs of loosening of the fasteners, otherwise adjustments should be made Correction or correction.

5.2 For the personal safety of the operator, the machine must be well grounded (**good Good grounding can effectively reduce electric shock injuries and protect personal safety**)



5.3 Air source treatment (see picture on the right)

1) Introduction of external air source:

Connect a section with an outer diameter of  $\text{Ø}0.31\text{in}$  One end of the flexible air tube is connected to the air source, and the other

One end and the air inlet connector of the pressure

regulating filter valve Fix it

in place and push the trachea into place

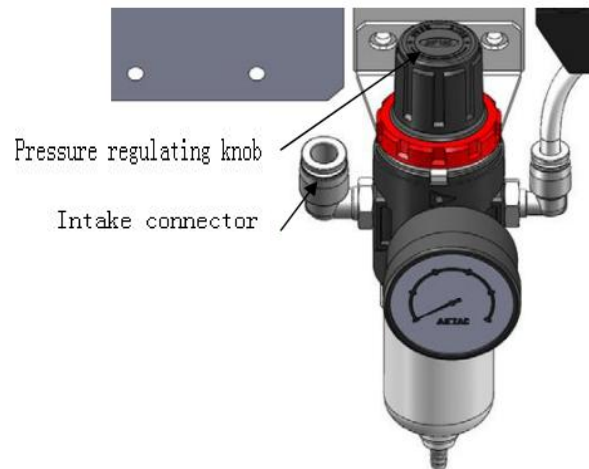

2) Check of air pressure:

When the air source pressure is  $\geq 6\text{kg.f/c m}^2$ , check Whether the pressure of the pressure gauge on the pressure regulating filter valve is  $4 \sim 6\text{kg.f/c m}^2$  (the pressure gauge is shipped from the factory The factory has been adjusted to the standard range), and the pressure of the machine should not exceed  $8\text{kg.f/c m}^2$ ,

otherwise the pneumatic components are easily damaged. Please note that the pressure of the air supply from the outside The force should not exceed 9kg.f/cm<sup>2</sup>, otherwise it will damage the pressure regulating filter and other pneumatic components.

### 3) Adjustment of air pressure:

If it is found that the pressure of the pressure gauge on the pressure regulating filter is not in the normal range, the following should be done Adjust, gently pull up the upper cover button of the regulator on the regulator filter, and turn it clockwise. Turn, the pressure increases, and vice versa, the pressure decreases. When adjusting the pressure, it must be adjusted gradually and evenly. To the required pressure, then press down the pressure regulating knob, and press down the bottom at the gap. Inside the boss on the seat (that is, locked state).

5.4 Turn the emergency stop button to the top end, press the green run button, and the machine enters the working state.

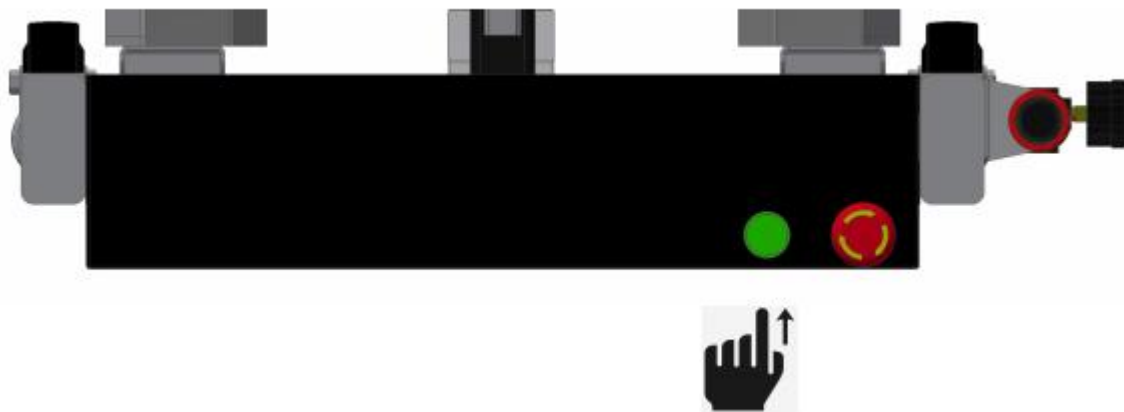

1) The user needs to open the box blank into the unpacking station to automatically fold the bottom front Back cover and side cover.



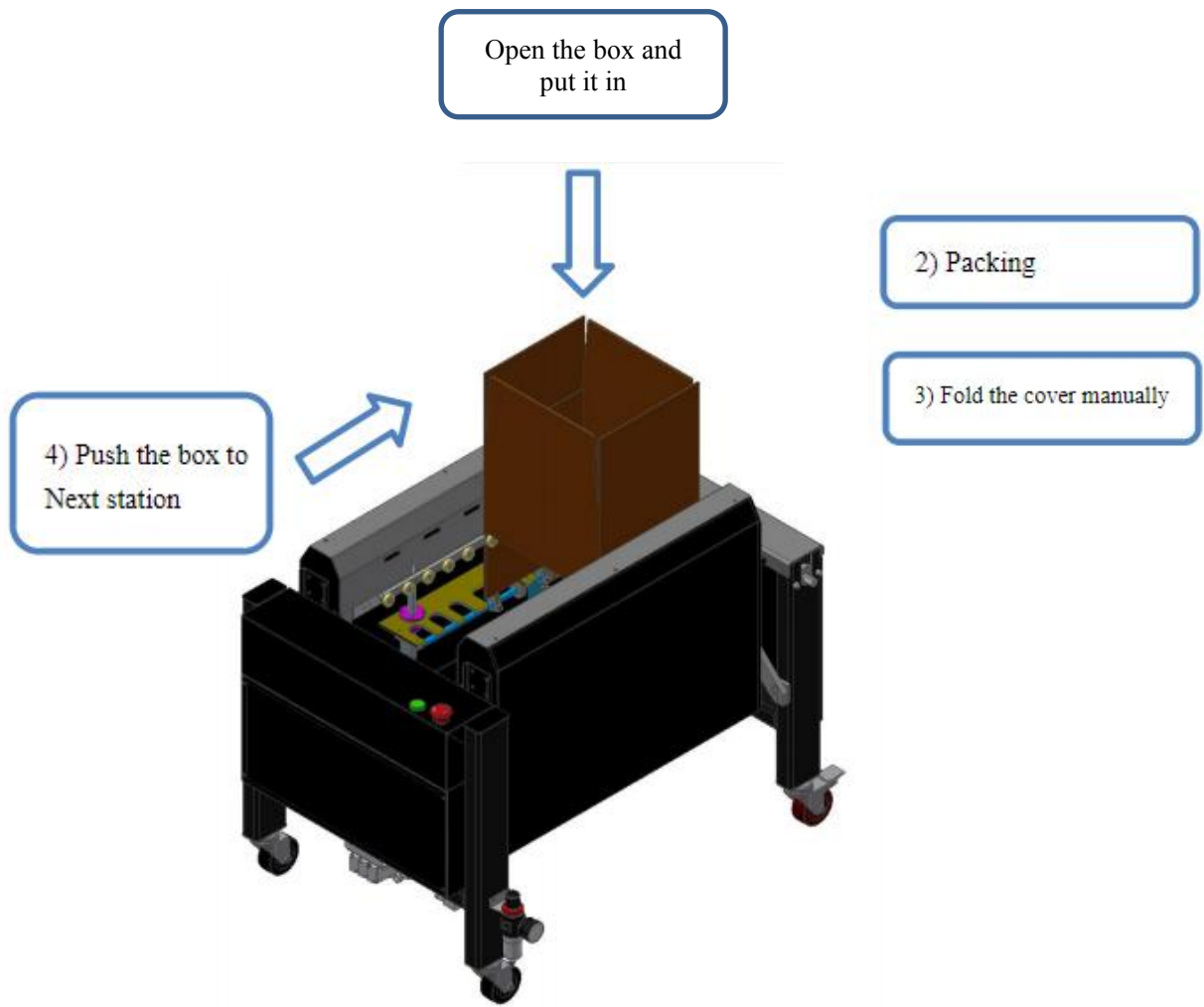

- 2) Maintain the current state and manually carry out packing.
- 3) After packing, manually fold the upper side cover and front and rear covers.
- 4) Push the box from the rear of the box to the next process.
- 5) The equipment is automatically reset and the next operation can be performed.

#### 5.5 Specification switching

- 1) Press the emergency stop button to cut off the power and gas to ensure safety.

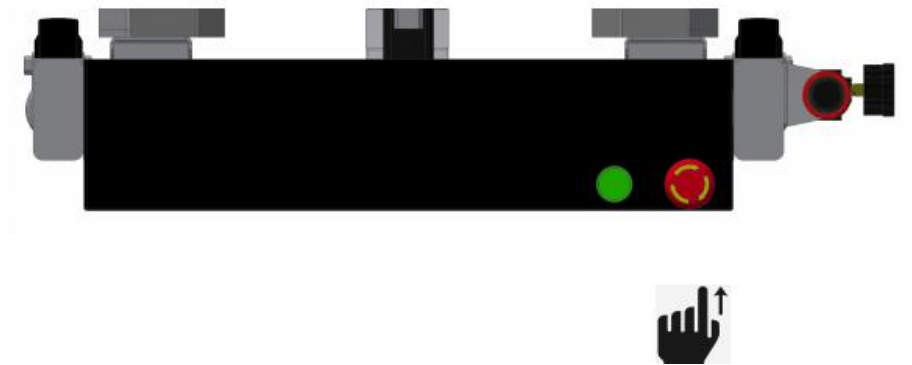

- 2) Adjust the width of the screw rod, counterclockwise rotation to increase the width, clockwise rotation to decrease the width. Width Slightly larger than the opened width of the box by 2-5mm, to ensure that the box will not be jammed and can be positioned left and right fix.

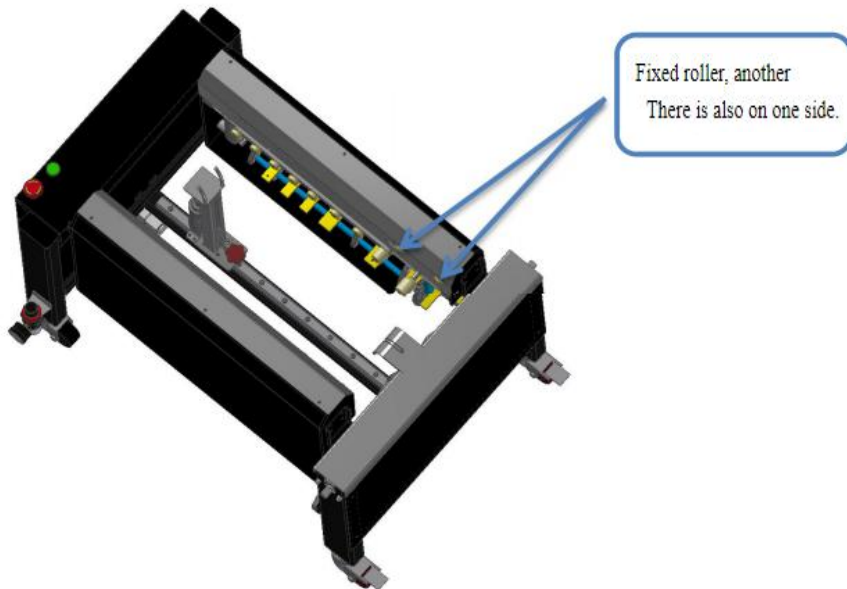
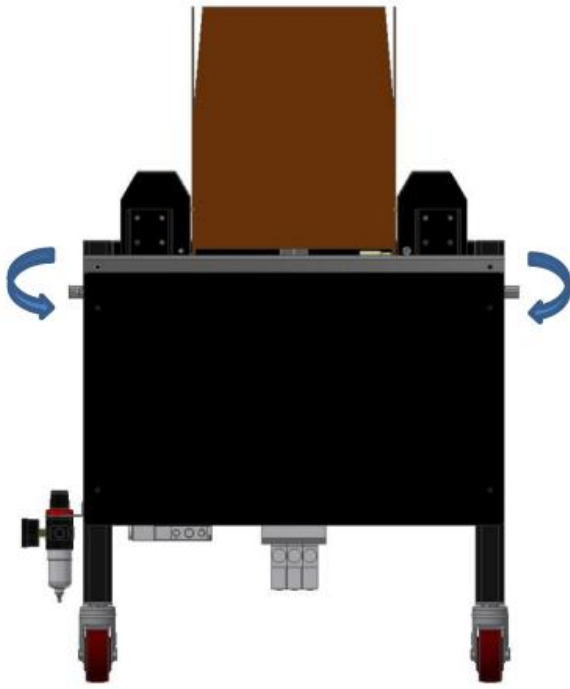

3) Unscrew the plum blossom handle, adjust the front and rear positions according to the length of the box, the total length of the front and rear is longer than the box

The degree is 5mm larger.

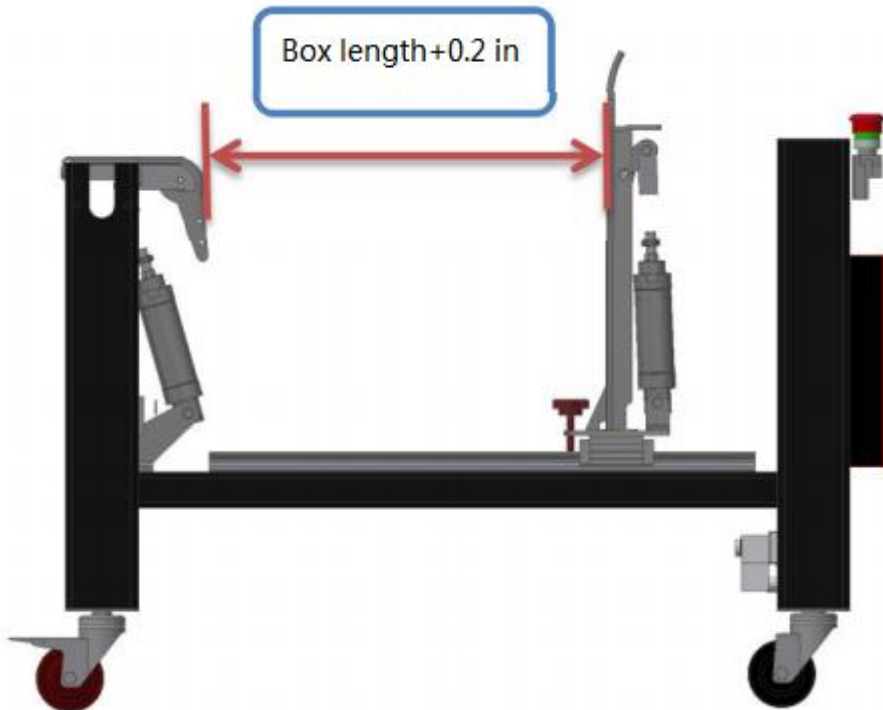
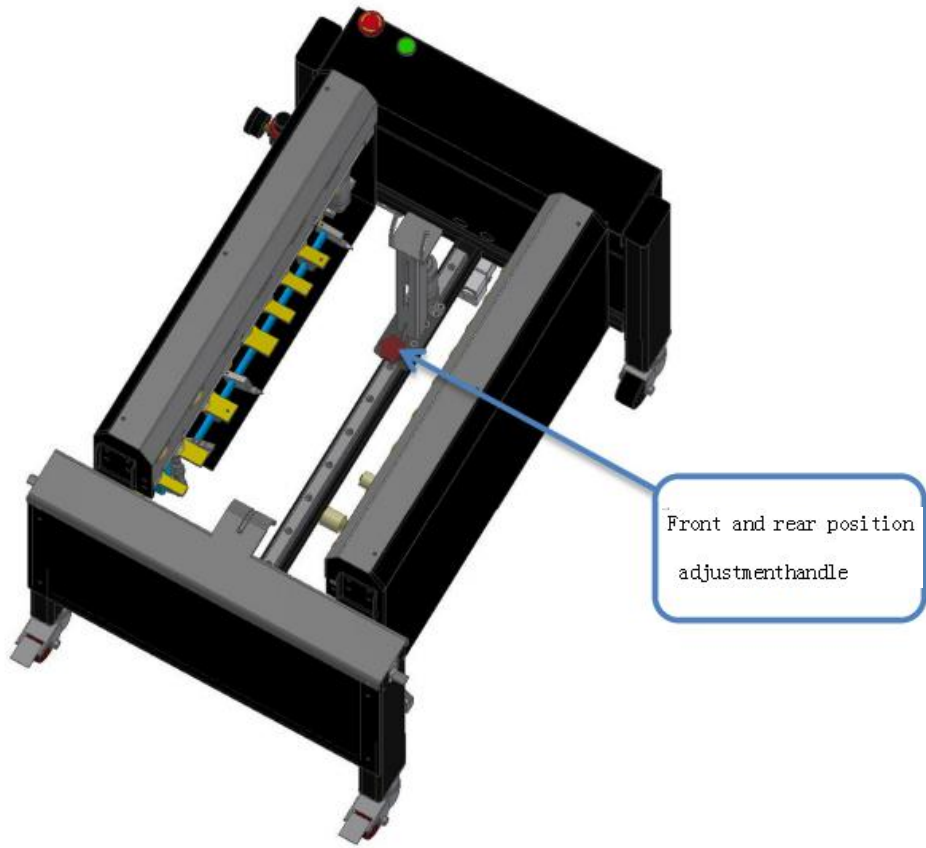

4) Routine adjustment can be ended in the third step. When the box has a large span, the size of the box needs to be suitable

When adjusting the length of the flanking rod.

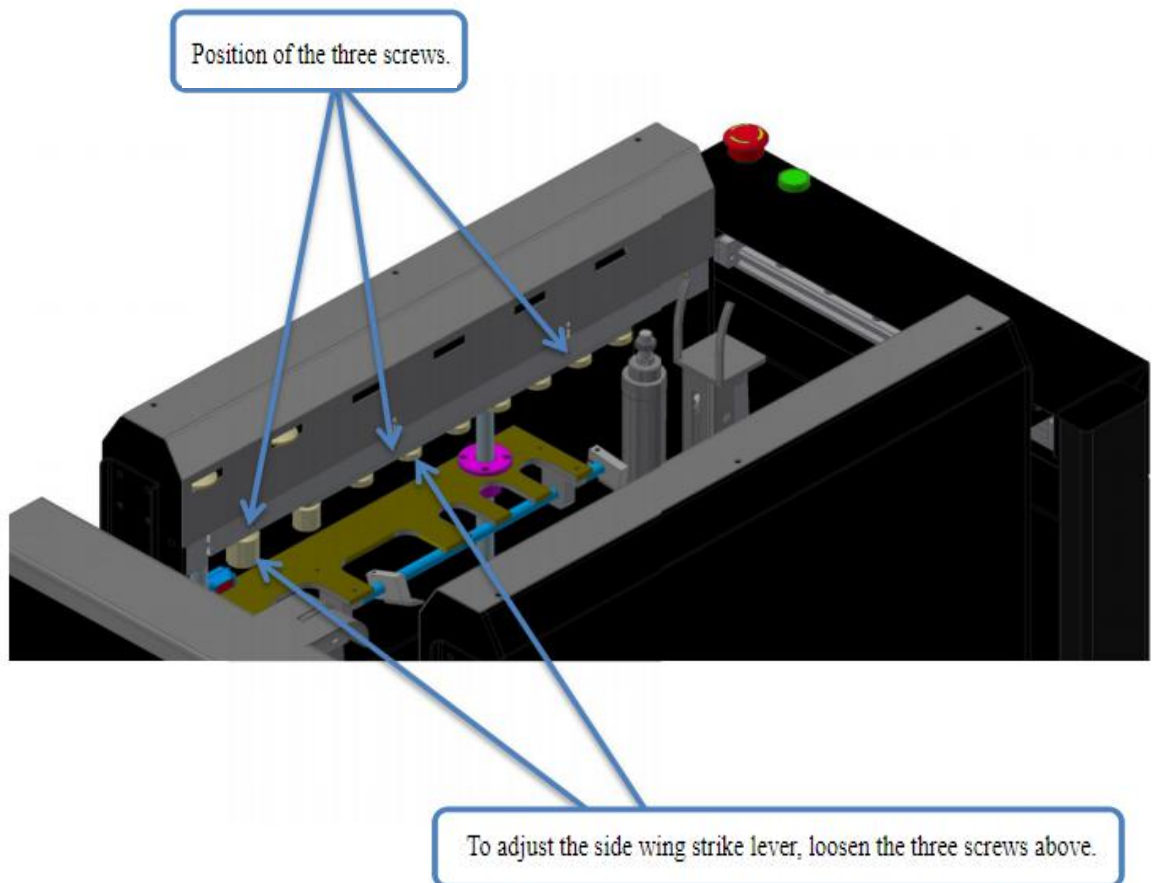

## 6. Circuit diagram

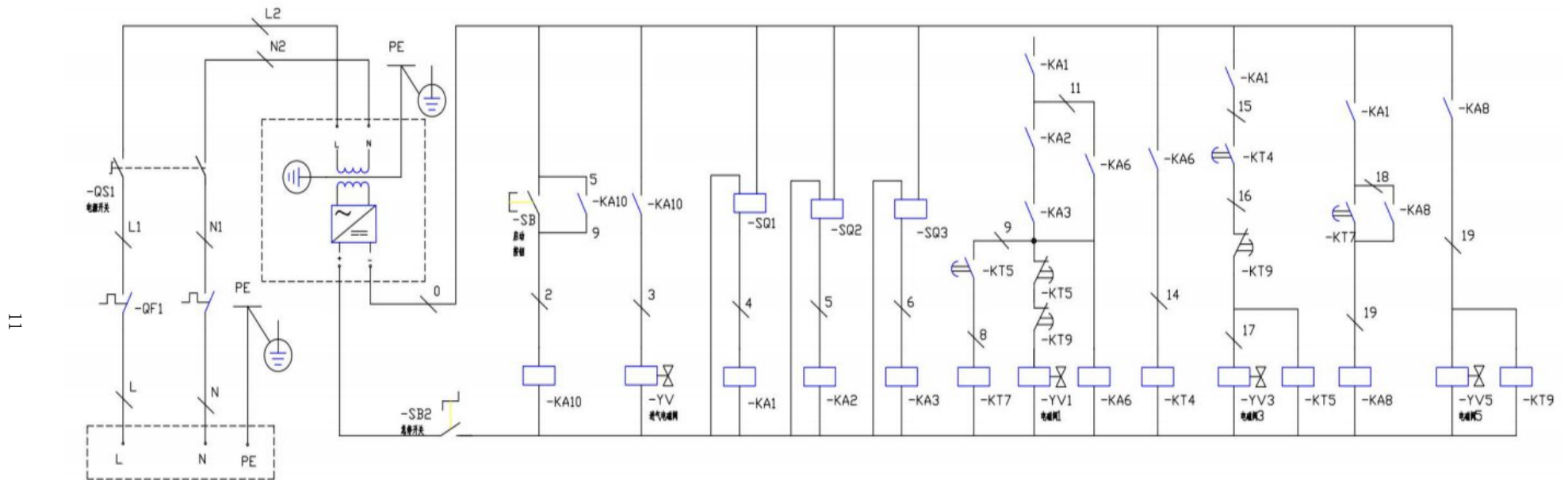

User power  
AC110V



## 8. Common troubleshooting

Failure phenomenon	Cause Analysis	elimination method
After the carton is pushed away,  the device is not reset	Photoelectric error detection	Clean up the photoelectric, and  you can use paint  The pen is painted black on the opposite side of the photoelectric.
After the bottom of the box is folded, the bottom left and right  are empty  Too big gap	The flanks are not long enough	Increase the length of the flanking  stick, the stick  Do not interfere with other parts.

## 9. maintenance and maintenance

9.1 Keep the inside and outside of the machine clean and dry.

9.2 The photoelectric must be kept clean and free of stickies.

9.3 Lubricate all transmission parts regularly.

9.4 Check all screws and nuts regularly, and tighten them in time if they are loose.

9.5 Discharge the water in the filter regularly.

9.6 Requirements for cartons

- 1) The carton must be kept dry (the damp carton is not hard enough to be unpacked by the machine).
- 2) The carton should not be too soft or have vertical creases.
- 3) The outer dimensions of the cartons to be sealed in the same batch must be the same (inconsistent outer dimensions will cause the machine The transmission of the device is blocked or cannot be transmitted).

9.7 Maintenance records and feedback forms

Thank you for purchasing the SmartK-03 semi-automatic box unpacking machine produced by our company. Because of your correct choice Selection, so that you have a safe, practical and efficient packaging machine, I hope you will become a long-term customer of the company Users, and please inform us in time of



the problems that arise during the use of the product and your valuable suggestions. We Will take it seriously and reply promptly, heartfelt thanks!

Special note: When debugging the machine, no part of the body can be in the machine In a movable position to avoid burns or bruises!

### Maintenance records and feedback

(This form is valid for copying)

User name :			Phone :	
Address :			Fax :	
Sales unit:			Purchase date:	
Model and name:			Invoice number:	
Serial number :	Failure and overhaul situation	Repair date	User unit representative (signature)	User units (Official seal)
Suggest:				